

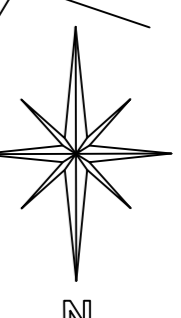

CADASTRAL PLAN

Scale: 1:2500

30KG CONCRETE HONEYCOMB BLOCK FILLED WITH COMPACTED SOIL



LAND TENURE SYSTEM
LEASEHOLD
PLOT AREA
A=0.051Ha. (510m²)
GROUND FLOOR
341.00m²
PLOT COVERAGE
PC=67% (building density)
PLOT RATIO
PR = 1.5 : 1 (Population density)

NWSC PLOT 19

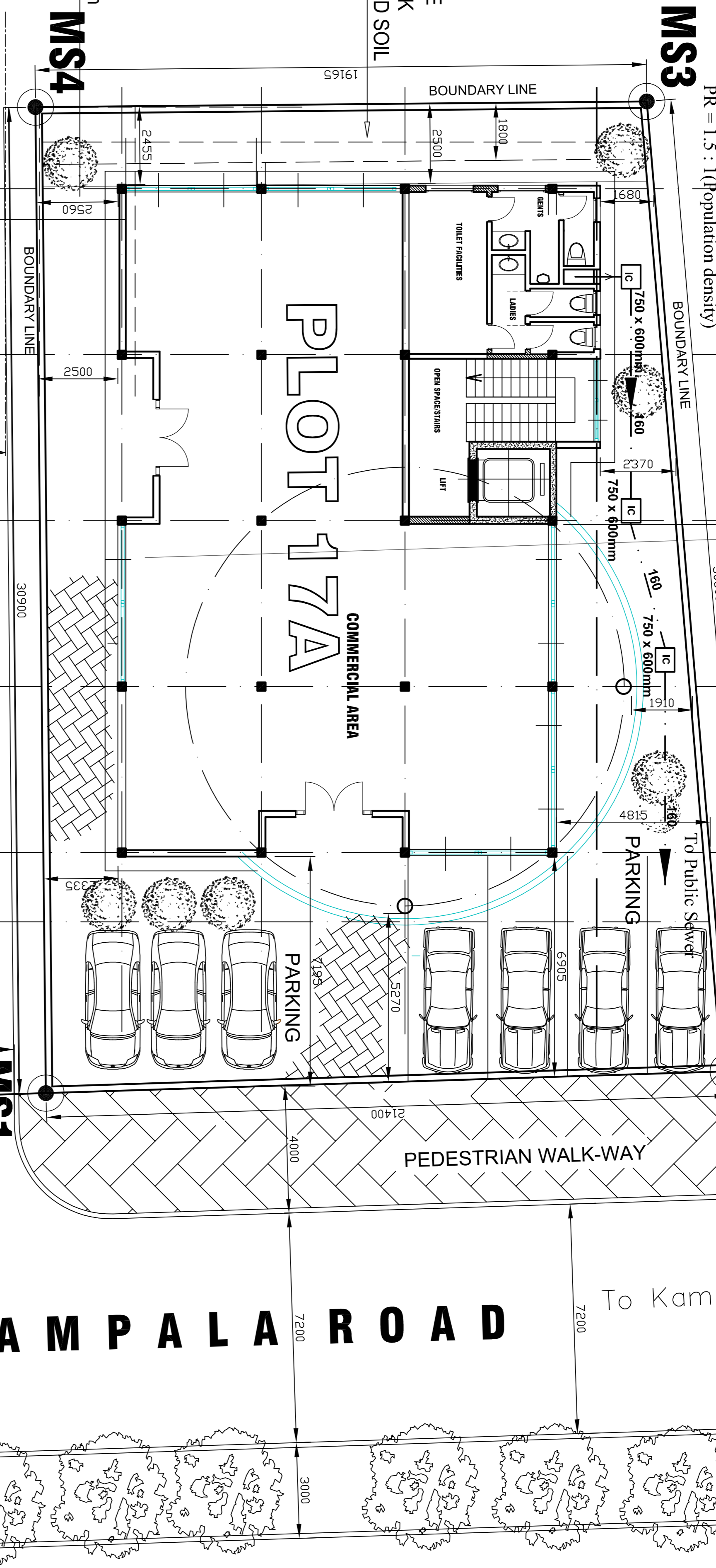
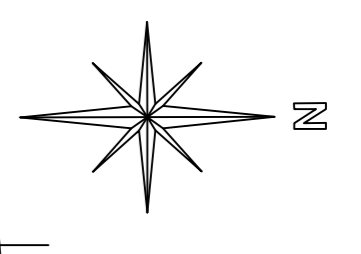

HONEY COMB RETAINING WALL
PLAN ARRANGEMENT VIEW (2 Lines)
Landscaping to Landscaper's Detail

Provide 300mm wide - 100mm deep drainage dish (Concrete Lining) To Direct Surface run off

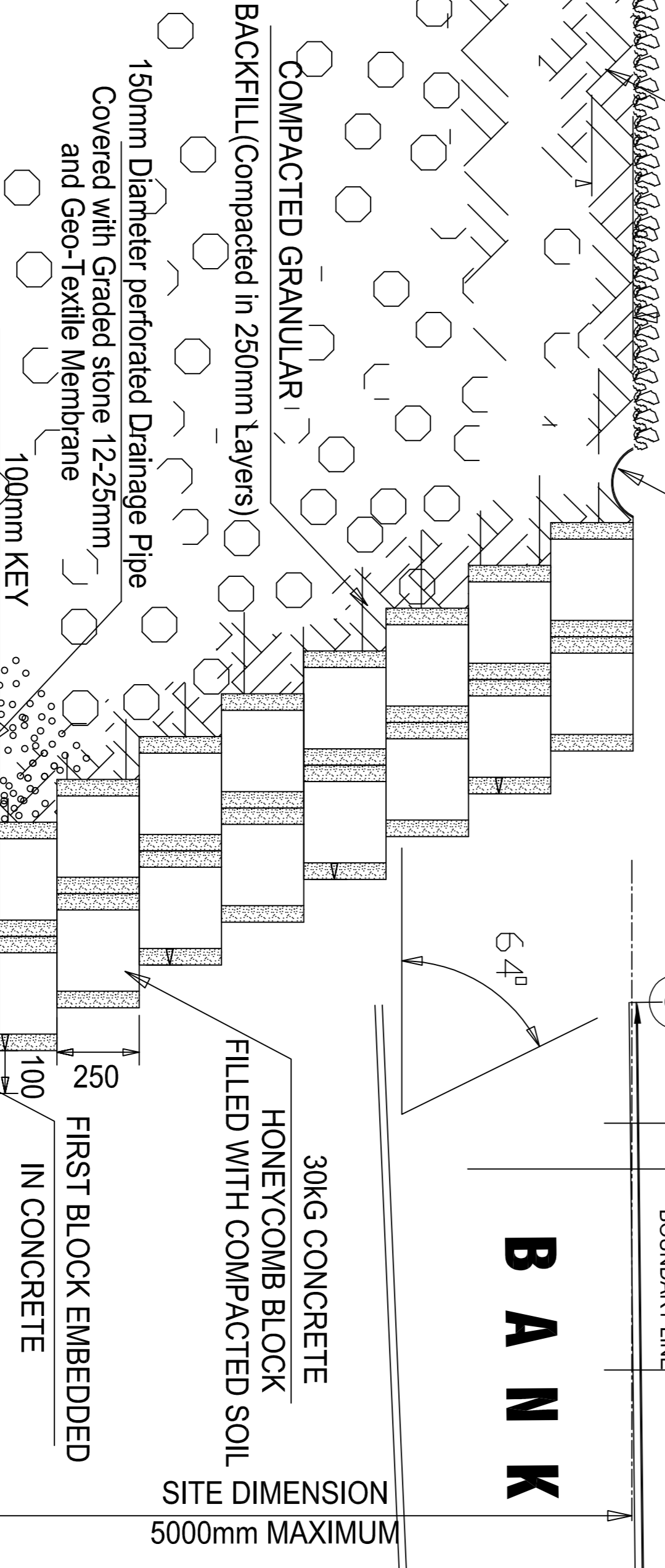

COMPACTED GRANULAR
BACKFILL(Compacted in 250mm Layers)
150mm Diameter perforated Drainage Pipe
Covered with Graded stone 12-25mm and Geo-Textile Membrane
100mm KEY
CONCRETE FOUNDATION
REINFORCED WITH T12 @ 250mm C/C
BOTHWAYS TOP AND BOTTOM

BASE CAST ON WELL COMPACTED
FILL / NATURAL GROUND
ENGINEER TO APPROVE BEFORE CASTING

BANK CLOSE BLOCK PLAN

Scale: 1:100

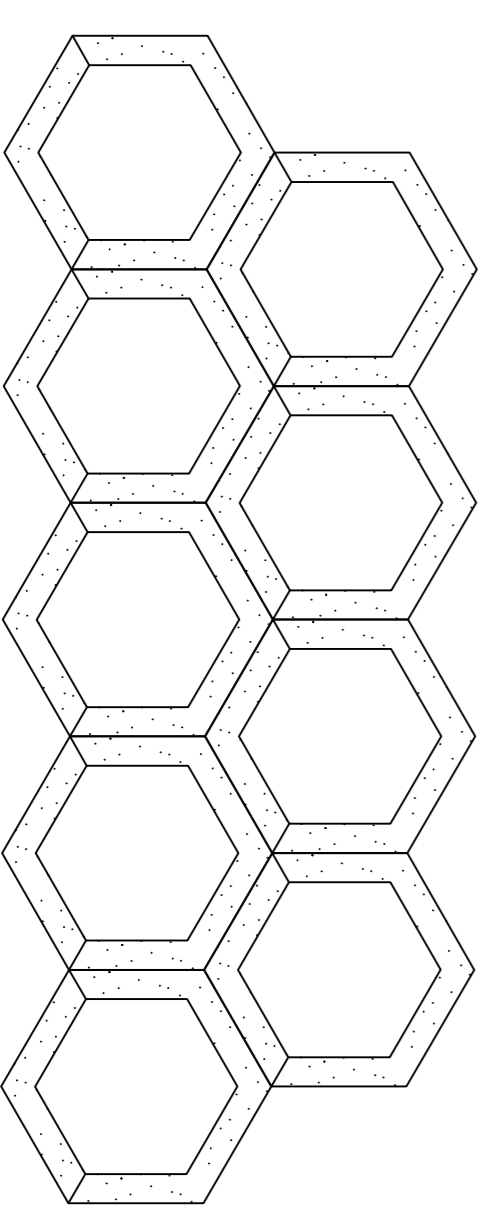

HONEY COMB RETAINING WALL
PLAN ARRANGEMENT VIEW (2 Lines)

KAMPALA ROAD

To Entebbe Airport

To Kampala

SPECIFICATIONS:
GENERAL:
All trades to conform to the requirements of the local authority and subject to the approval and inspection by the local building inspector. All figured dimensions in preference to scaling.
All materials to be checked by contractor on site prior to commencing any work.
All materials to comply with the local building standards.
Temporary abutment facilities to be erected and must conform to local authority requirements.
Electrical and plumbing works to be performed by registered artisans.
Electrical and plumbing works to be in accordance with national building regulations.
Balustrades where applicable - min. height 1050, opening not to exceed 125mm.

OWNER'S SIGNATURE:
The signature hereto confirms that the signatory is authorized to sign and accept plans and has inspected and approved the plans and accepted them entirely.

General Notes

- All dimensions to be checked on site, written dimensions to be in preference to scaled dimensions
- All sites less than 200mm thick to be reinforced with 300mm iron at every alternate course
- Structural steelwork to be in accordance with structural engineer's details
- All sanitary work to be in accordance with local Authority Rules and Regulations
- Where drain passes under building or drive-way area pipe to be of cast iron or encaased in 150mm concrete
- All water pipes and soil pipes are to be in ducts and 100mm diameter and external along and down side of floor to have bungler proofing to architect's detail
- All door frames to be rabbled, moulded and the full width of wall with moulded architraves to detail provide rubber door stops to all doors
- Staircase and lobby doors to be self-closing and 1/2 hour fire resistant
- All internal plaster to be two coats steel float
- All panholes within building area drive-way and parking to be 1.2m high and 1.2m wide and double sealed
- GI low outlet with brackets etc. where shown
- All painting to be 3 coats
- 1.5m layer of paving slabs 600x600 on sand along perimeter of the building where shown
5. Samples of fittings materials etc. to be produced and approved before commencing work
- All windows to have P.C. clits built-in P.V. Palmat boxes and timber internal window clits and shiftings
- Steel trusses/portal frames and purlins to be painted with 2 coats of oil paint
- Fire fighting equipment to be provided and installed by Building Fire Consultants where shown on plan

PROPOSED DRAWINGS FOR
SUBMISSION TO LOCAL
AUTHORITY FOR APPROVAL

AUTODESK, INC.
DESIGNED, DRAWN & PRODUCED BY:
ARCH. HAPPY HERBERT KASORO
Dip. OJGCE BA. Arch. Msc. Arch. M.A.USA

Smart Globe Architects Ltd
Architects & Planning Consultants
Plot. 889 Kirinya-Bukasa
P.O. BOX 348, Kampala
Tel. 0772-403888
email: smartglobe20113@gmail.com

Smart Globe Architects Ltd
Architects & Planning Consultants
Plot. 889 Kirinya-Bukasa
P.O. BOX 348, Kampala
Tel. 0772-403888
email: smartglobe20113@gmail.com

CLIENT
CHINPAWE SANCTUARY & WILDLIFE CONSERVATION TRUST
P.O. BOX 884
ENTEBBE

PROPOSED COMMERCIAL BUILDING ON
ENTEBBE MUNICIPALITY

DATE	SCALE	PROJECT LOCATION
APRIL 2014	1:100, 1:50	ENTEBBE MUNICIPALITY
DWG. No.	SHEET	
01-04-2014-EBB	17A	KAMPALA ROAD
		01-06