

**SCHEDULE OF OPENING**

SL.NO	TYPE	DESCRIPTION	SIZE
1	D	DOOR	0.80 X 2.10
2	D1	DOOR	1.20 X 2.10
3	D2	GLASS DOOR	2.40 X 2.40
4	W1	WINDOW	1.50 X 2.20
5	W2	WINDOW	0.75 X 1.90
6	FG1	FIXED GLASS	2.60 X 2.85
7	SG1	STRUCTURAL GLAZING	4.9 X 2.20
8	SG2	STRUCTURAL GLAZING	4.10 X 2.20
9	SG3	STRUCTURAL GLAZING	4.20 X 2.20
10	SG4	STRUCTURAL GLAZING	4.33 X 2.20

Wall finishes to Kitchen:  
 Tiles - 1.5m high, plaster & paint remainder  
 Wall finishes to Bathrooms:  
 Tiles - Full height  
 Showers - Tiled - full height

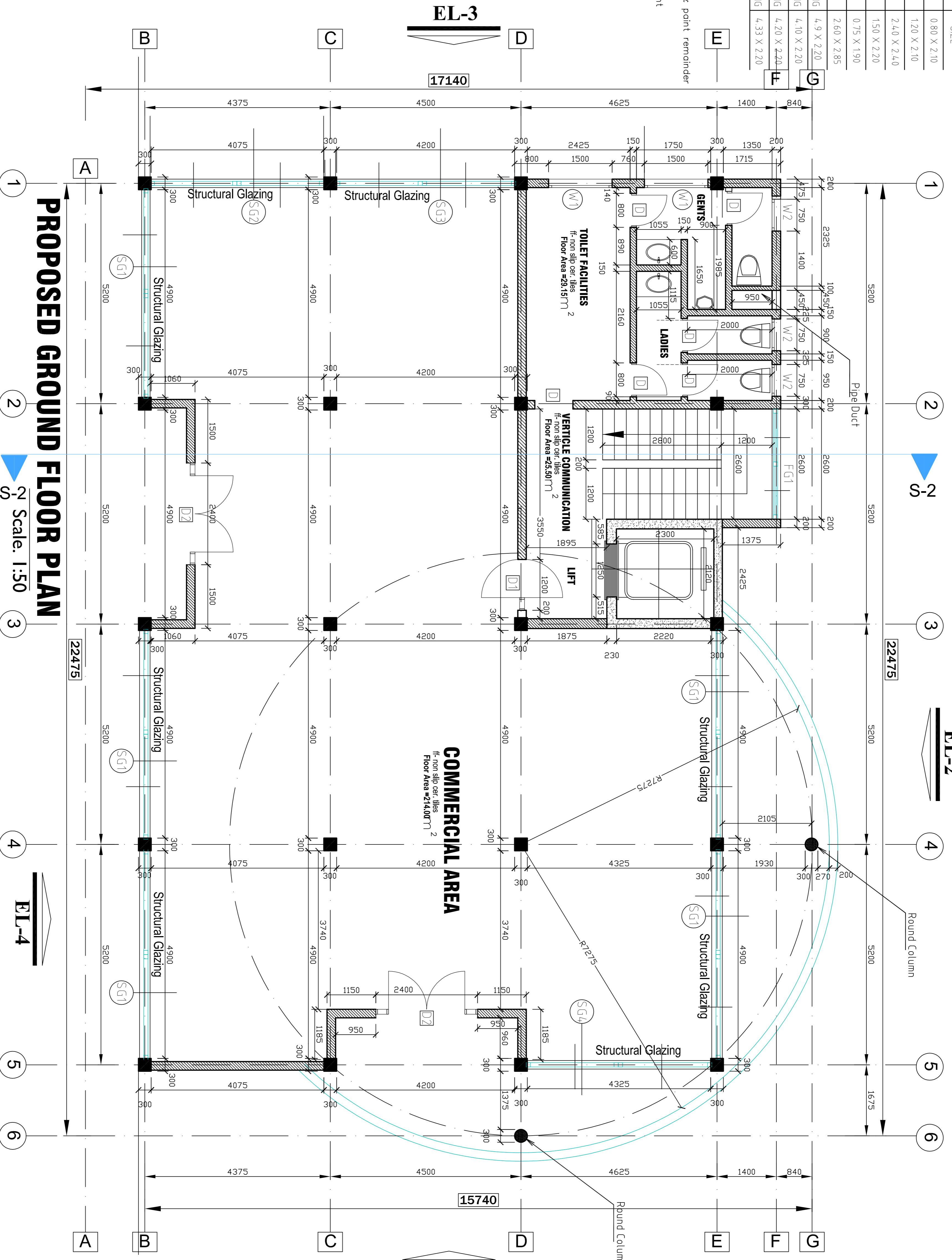

**PROPOSED GROUND FLOOR PLAN**

Scale: 1:50

**FOUNDATIONS:**

Excavate foundations onto solid undisturbed ground and not to be less than 1.5m below NGL.  
 Brickwork below NGL.  
 Bricks to be hard burnt "foundation" bricks or concrete bricks.  
 Standard 630 x 230 foundations to walls for single storey buildings and 700 x 300 conc. foundations to double storey buildings where ground is stable.  
 Minimum strength to be 20 MPa, Class 2.  
 Foundation walls: Minimum strength 7MPa, Class 2.  
 Soil to be examined and approved for foundations by engineer.

**GLAZING:**

0 - 0.75sqm = 3mm, 0 - 1.5sqm = 4mm, 1.5sqm & greater = 6mm - All glazing to comply with local building standards.  
 Safety markers to be fixed to all sliding door panes.  
 Provide laminated safety glass to glass sliding doors & all doors & windows where glazing is within 900mm above floor level.

**GLAZING:**

0 - 0.75sqm = 3mm, 0 - 1.5sqm = 4mm, 1.5sqm & greater = 6mm - All glazing to comply with local building standards.  
 Safety markers to be fixed to all sliding door panes.  
 Provide laminated safety glass to glass sliding doors & all doors & windows where glazing is within 900mm above floor level.

OWNER'S SIGNATURE:  
 The signatory hereto confirms that the signatory is authorized to sign and accept plans and has inspected and approved the plans and accepted them entirely.

- General Notes**
- All dimensions to be checked on site, written dimensions to be in preference to scaled dimensions.
  - All slits less than 200mm thick to be reinforced with 10mm iron at every alternate course.
  3. All slits less than 200mm thick to be reinforced with 10mm iron at every alternate course.
  4. All sanitary work to be in accordance with local Authorities Rules and Regulations.
  5. Where drain passes under building or drive-way area pipe to be of cast iron or encased in 150mm concrete.
  6. All water pipes and soil pipes are to be in ducts and ducts to be in concrete.
  7. All windows and external glass doors are to have burglar proofing to architect's detail.
  8. All door frames to be rabbled, moulded and the full width of wall with modified architraves to detail, provide rubber door stops to all doors.
  9. Staircase and lobby doors to be self-closing and 1/2 hour fire resistant.
  10. All internal plaster to be two coats steel float.
  11. All masonry within building area to be rendered and painted to 2 coats with white emulsion paint.
  12. All external walls to be rendered and painted to 2 coats with white emulsion paint.
  13. All painting to be 3 coats.
  14. 1st layer of paving slabs 600x600 on sand along perimeter of the building where shown.
  15. Samples of fittings/materials etc. to be produced and approved before commencing work.
  16. All windows to have P.C. clits built-in P.V. Palmat boxes and timber internal window cills and sills.
  17. Steel trusses/portal frames and purlins to be painted with 2 coats of oil paint.
  18. Fire fighting equipment to be provided and installed by Building Fire Consultants where shown on plan.

**PROPOSED DRAWINGS FOR SUBMISSION TO LOCAL AUTHORITY FOR APPROVAL**

DESIGNED, DRAWN & PRODUCED BY:  
**ARCH. HAPPY HERBERT KASORO**  
 Dip. OmbE BA. Arch. Msc. Arch. AU/USA

**AUTODESK, INC.**

PC. No. **1902**  
 YEAR **2014**  
 SHEET No. **125**

**Smart Globe Architects Ltd**  
 Architects & Planning Consultants  
 Plot. 889 Kinyua-Bakasa  
 P.O. BOX 348, Kampala  
 Tel. 0772-403888  
 email: smartglobe2013@gmail.com

CLIENT: **CHIMPANZEE SANCTUARY & WILDLIFE CONSERVATION TRUST**  
 P.O. BOX 894  
 ENTebbe  
 PROJECT: **PROPOSED COMMERCIAL BUILDING ON ENTebbe MUNICIPALITY**

DRAWING TITLE: **PROPOSED PLANS**  
 DATE: **APRIL 2014**  
 DRAWN BY: **WAKISO**  
 CHECKED BY: **WAKISO**  
 PROJECT LOCATION: **17A KAMPALA ROAD**  
 SHEET No. **01-04-2014-EBB**  
 SHEET **02-06**